

OWNERSHIP AND USE OF DOCUMENTS:  
THESE PLANS AND SPECIFICATIONS AS INSTRUMENTS OF SERVICE ARE AND SHALL REMAIN THE PROPERTY OF MICHAEL K REMPEL ARCHITECTS P.C. NO PART OF THE PROJECT FOR WHICH THESE ARE INTENDED IS EXECUTED, THESE PLANS AND SPECIFICATIONS SHALL NOT BE USED ON ANY OTHER PROJECT WITHOUT THE WRITTEN AGREEMENT IN WRITING WITH MICHAEL K REMPEL ARCHITECTS P.C. ALL RIGHTS RESERVED.

**TIMBERS RESIDENCE**  
HUTCHINSON, KANSAS  
MARK BORECKY CONSTRUCTION



PROJECT # MB 1107  
DRAWN BY MKR  
REV:

SHEET  
**A1.1**  
09-14-11

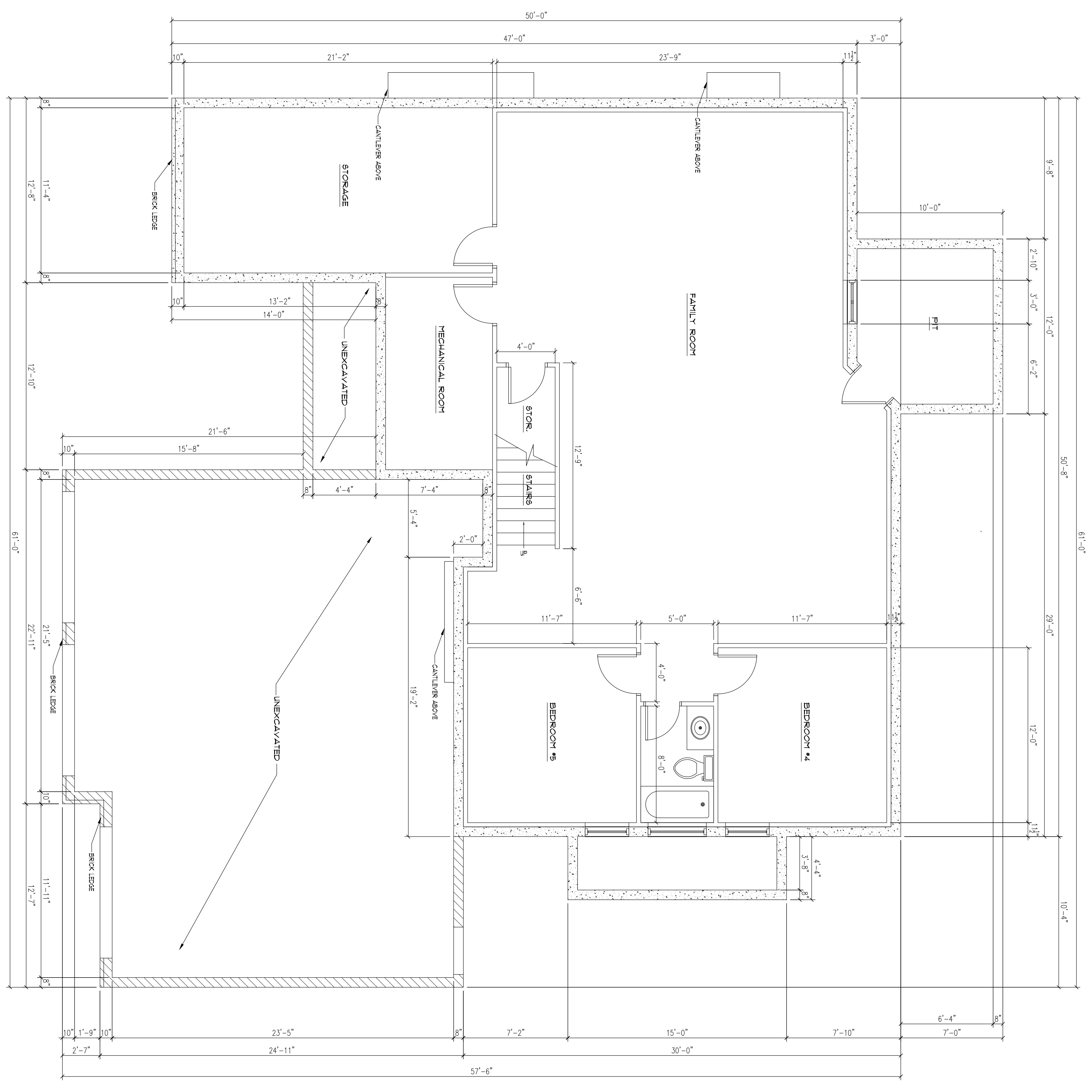

**1** BASEMENT LEVEL FLOOR PLAN  
A1.1 SCALE: 1/4" = 1'-0"  
MB 1107

**M I C H A E L M R E M P E L A R C H I T E C T S**  
809 LAFAYETTE PARKWAY  
WILLIAMSPORT, PA 17701  
570-772-2390  
MREMP@MKRARCHITECTURE.COM